

## WDKIT

### Replacement Paddle Instructions

The kit includes a snap-on replacement switch paddle and a decorator wall plate with two mounting screws.

1. Using a small screwdriver, pry up on the edges to remove the existing paddle from the switch.
2. Align the replacement paddle over the switch being sure to align the air gap switch slot over the air gap switch.
3. Snap the replacement paddle securely onto the switch.
4. Attach the wall plate to the switch with the two screws provided.

**Linear**<sup>®</sup>  
*Building On Innovation.*

USA & Canada (800) 421-1587 & (800) 392-0123  
(760) 438-7000 - Toll Free FAX (800) 468-1340

[www.linearcorp.com](http://www.linearcorp.com)

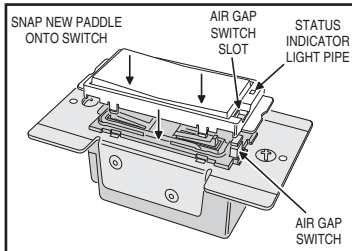
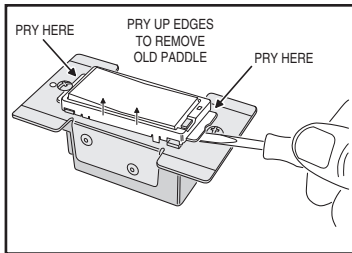

P1923 X3